

HA 500

EN

Air purifier

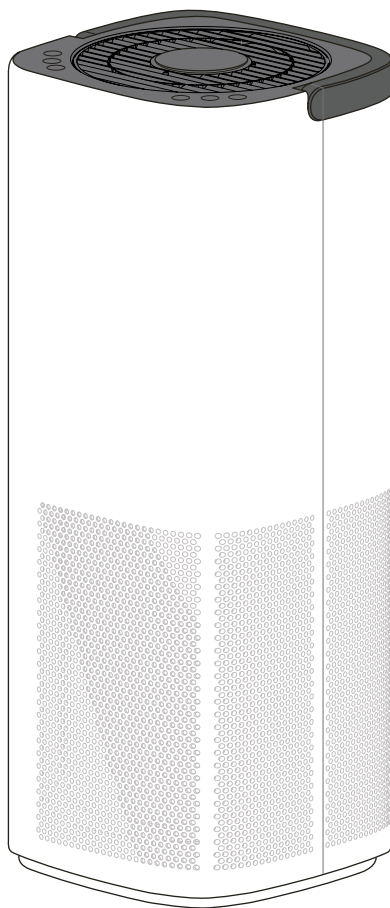

User manual

horizon

A I R P U R I F I E R

HA 500

Air purifier

INDEX

1	Precautions	4
2	Name of each part	11
3	Features	12
4	Operation/Indication part	13
5	How to use	16
6	How to replace the filter	17
7	Cleaning method for pre-filter	19
8	Solution to common problems	20
9	Specifications	21
10	Warranty	22

To keep the best working conditions and guarantee long life, read this manual carefully before you operate this equipment.

1. PRECAUTIONS

Read carefully following precautions to prevent unpredictable dangers and damages.



DANGER: If not observed, serious injury or even death could occur.

WARNING: If not observed, Slight injury of property damage could occur.

CAUTION: If not observed, Slight injury of property damage could occur.

PRECAUTIONS FOR POWER SUPPLY



1. This product must be plugged into AC120V outlet.

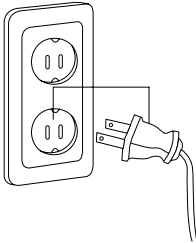

* It could cause a fire or electric shock.



2. Before use, please wipe dust of other foreign substances off on the plug.



* It could cause a fire or electric shock.



3. Please do not use when the plug is damaged or swinging.

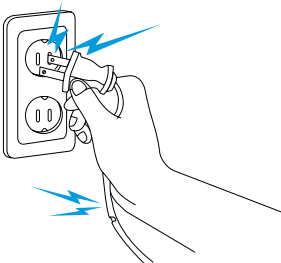

* It could cause a fire or electric shock.

* When the plug is damaged, contact customer service center or your purchasing place.



4. Before replacing filter, please unplug the power cord.

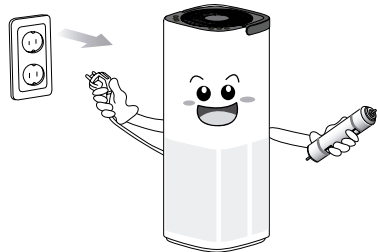

* It could cause electric shock.

PRECAUTIONS FOR POWER SUPPLY



5. Please do not try to bend, tie or pull the power cord.

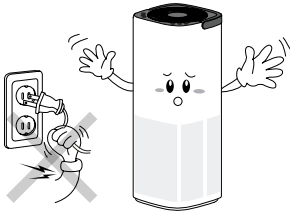

* It could cause a fire by electric shock.



6. The outlet should be rated for more than 16A. Use a separate outlet for the unit.

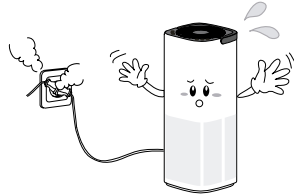

* Do not plug too many cords into the outlet. It could cause a fire.



7. Please do not disassemble or modify the plug.

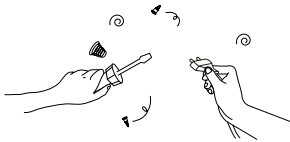

* It could cause a fire or electric shock.



8. Please do not plug in or unplug the power cord with wet hands.

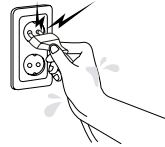

* It could cause electric shock.



9. Please do not unplug the unit by pulling out its power cord.



* It could cause a fire or electric shock



10. Do not severely bend the power cord or put heavy object on it.



* It could cause a fire.

PRECAUTIONS FOR INSTALLATION



1. Avoid heat and direct sunlight.

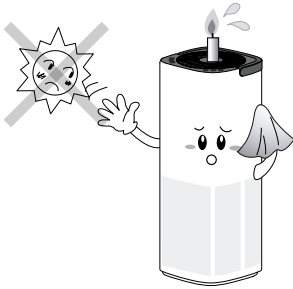

* It could cause deformation of the exterior.



2. Do not place the unit on an unstable or sloped surface.



* It could cause malfunction.



3. Do not place the unit near inflammable materials.

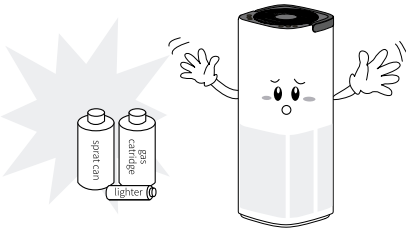

* It could cause an explosion and fire.



4. Please do not install the unit at a moist place like bathhouse, shower room or swimming pool.



* It could an electric shock or fire.



5. Do not disassemble, repair or modify by yourself.

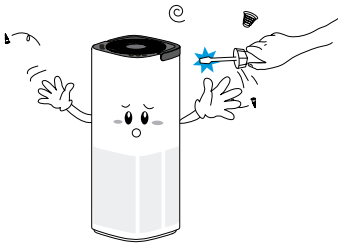

* It could an electric shock or fire.



6. Maintain a sufficient distance from inflammable materials. At least 40 inches is recommended.

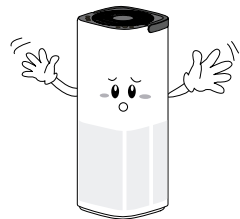

PRECAUTIONS FOR INSTALLATION



7. Do not insert a sharp wire and screwdriver into the unit inside.

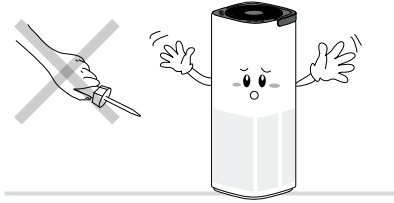

* It could cause electric shock or malfunction.



8. Do not touch the interior of the product with wet hands.

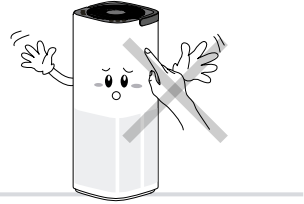

* It could cause electric shock.



9. Do not apply severe impacts to the unit.

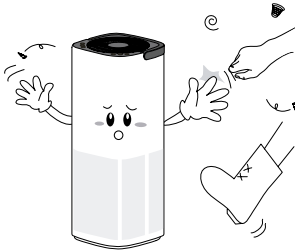

* It could cause malfunction, damage or electric shock.



10. Do not move the unit while it is being operated.



* It could cause malfunction.



11. Do not put heavy stuff on the unit.



* It could cause damage to the unit.



12. Do not spray pesticide or flammable liquids.

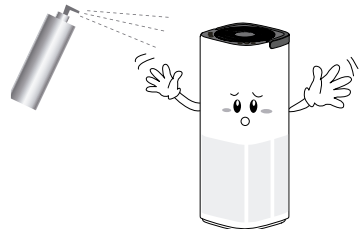

* It could cause a malfunction.

PRECAUTIONS FOR USE



1. Do not operate the unit without filters.

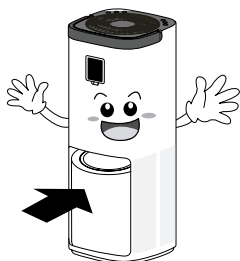

* It could cause electric shock and product life cycle reduction.



2. Cover the unit when it is not in use for a long time.

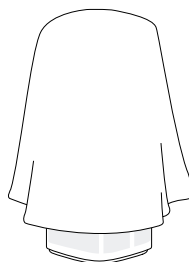

* It could cause malfunction.



3. Do not use the unit in greasy or dusty places such as restaurants, kitchens or construction site.

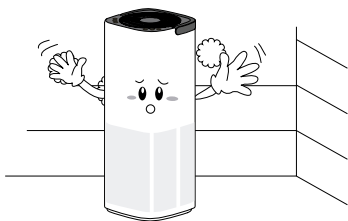

* It could cause contamination of sensor and shortening of filter lifetime.



4. Do not use the unit in a place that has much of toxic gases.

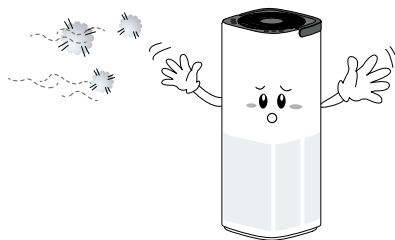

* It could cause malfunction.



5. Do not use the unit in extremely cold or hot place.

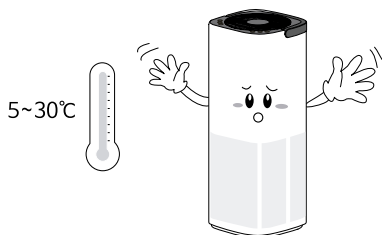

* Optimum temperature for use is between 5°C and 30°C.



6. Do not spray the unit with water.

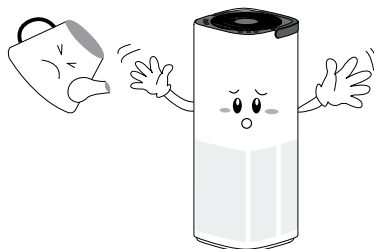

* It could cause electric shock or malfunction.

PRECAUTIONS FOR USE



7. Do not insert anything into the air inlet or outlet.

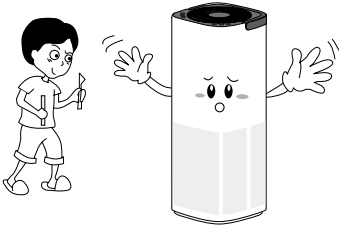

* Especially it requires attention for children.
It could cause burns, electric shock and failure.



8. Stop using the unit if any irregular noise or smoke occurs.

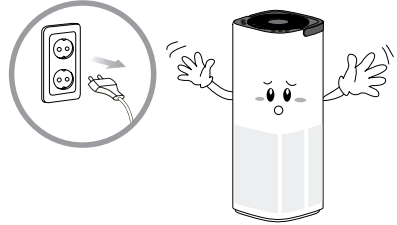

* Pull out the plug and then call the customer service center.



9. Do not block the air inlet or outlet.



* It could cause malfunction.



10. Do not use the unit for any other purpose than indoor air purification.

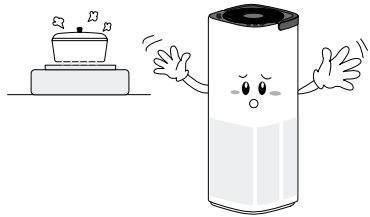

* if used in the kitchen instead of ventilator, the filter replacement cycle will be shorten.



11. Do not insert anything like a coin or chopsticks into the inside of the upper grill.



* It could cause malfunction and damage.



12. Do not allow children to play on or near the unit.

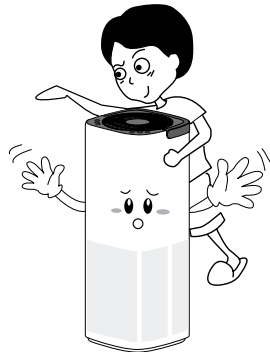

SAFE PLACE FOR INSTALLATION

- Indoor space protected from direct sunlight
Direct sunlight may cause a malfunction of the product
Dry and well-ventilated place
- Avoid humid and windtight place
Install the product on the hard and flat area
- If the product is installed on the inclined and weak place, it could make noise and vibration.
It should be installed at a space of 10cm far from wall.

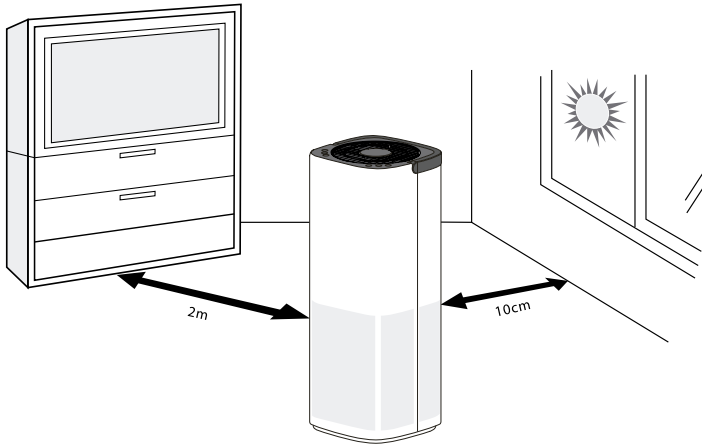

INFORMATION

- Tighten the filter before using and replace it if there is an abnormal odor from the product.
The best quality of air-cleaning could not be expected if the filter is not connected to the product.
The quality of cleaning air could be less if the filter is dirty. If the filter gets dirty or makes an abnormal odor and a weak air-flow, it must be replaced.
- Reduce the use of the air purifier when cooking foods that occurs much odor such as fish.
If you use the product while cooking a food with bad odor, the life of the deodorant filter could be shortened. In severe cases, the product could make an odor when you use it after ventilating with a filter permeated with odor.
If the product makes an odor from the permeated UPFF (Ultrafine Particle Free Filter) and deodorant filter, replace the filter with new one.
- Close the door and window while using the product
The quality of air-cleaning could be less if window or door is opened.
Unremovable poisonous gas : carbon monoxide (CO)

2. NAME OF EACH PART

HORIZON HA 500

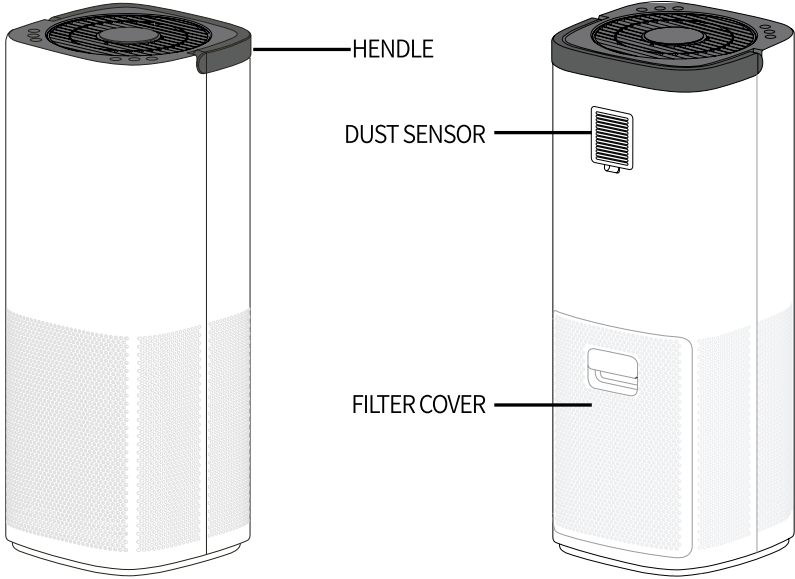

<FRONT SIDE>

<BACK SIDE>



<TOP SIDE >

3. FEATURES

- **Convenient handle**

With the ergonomic handle, you can easily move the product.

- **Grill rotate feature**

It improves air circulation by rotating air ventilation grill.

- **Dust sensor**

It displays the number of the air pollution level with the dust sensor which is able to detect PM 2.5 (ultrafine particles) You can easily check the air pollution level of PM2.5(Ultra fine particles) categorized by colors.

- **Various modes of operation**

Manual/Automatic/Sleep modes are available. It always make fresh the indoor air by adjusting air-flow automatically according to the air pollution level of PM2.5(Ultra fine article) In the sleep mode, the purifier operates with the lowest air-flow and the light of the indicator gets dark not to disturb your sleep.

- **Lock mode**

With the lock mode, you can prevent the use caused by children or other reasons.

- **3 Stage of Filter**

- PRE filter : It filters contaminants such as dust, fur, pollen etc. in the air.

- UPPF (Ultrafine Particle Free Filter): It removes fine contaminants such as dust, bacteria, mold, smoke and etc. in the air.

- Deodorant filter : It keeps fresh room air by removing formaldehyde and various odors that cause Sick House Syndrome.

- **Generation of Cluster ion**

Hydrogen ion(H+) and oxygen ion(O²⁻) released from the purifier and combined with water makes Cluster ion makes OH radical by sticking at contaminants.

As OH radical is oxidative, it removes contaminants.

4. OPERATION/INDICATION PART

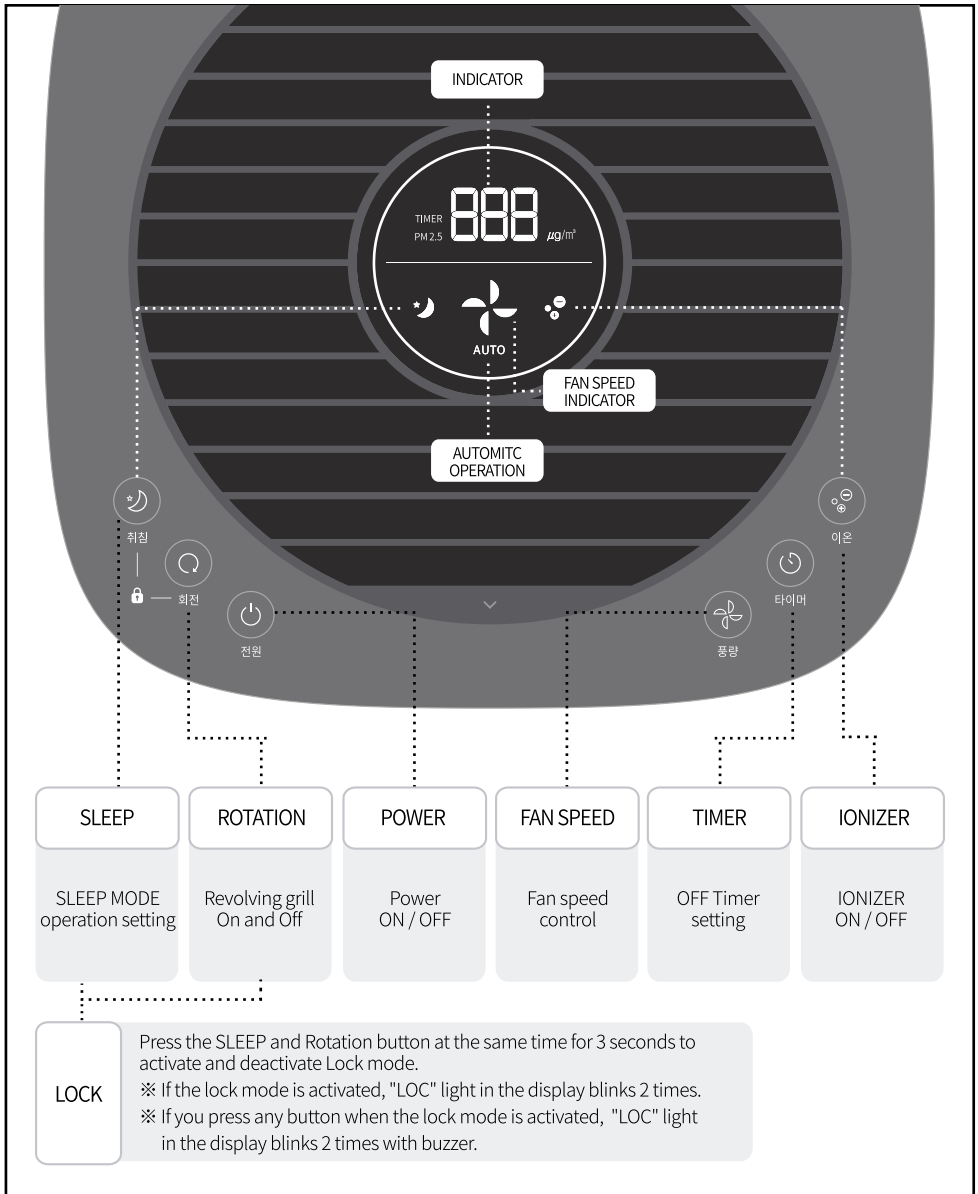

4. OPERATION/INDICATION PART

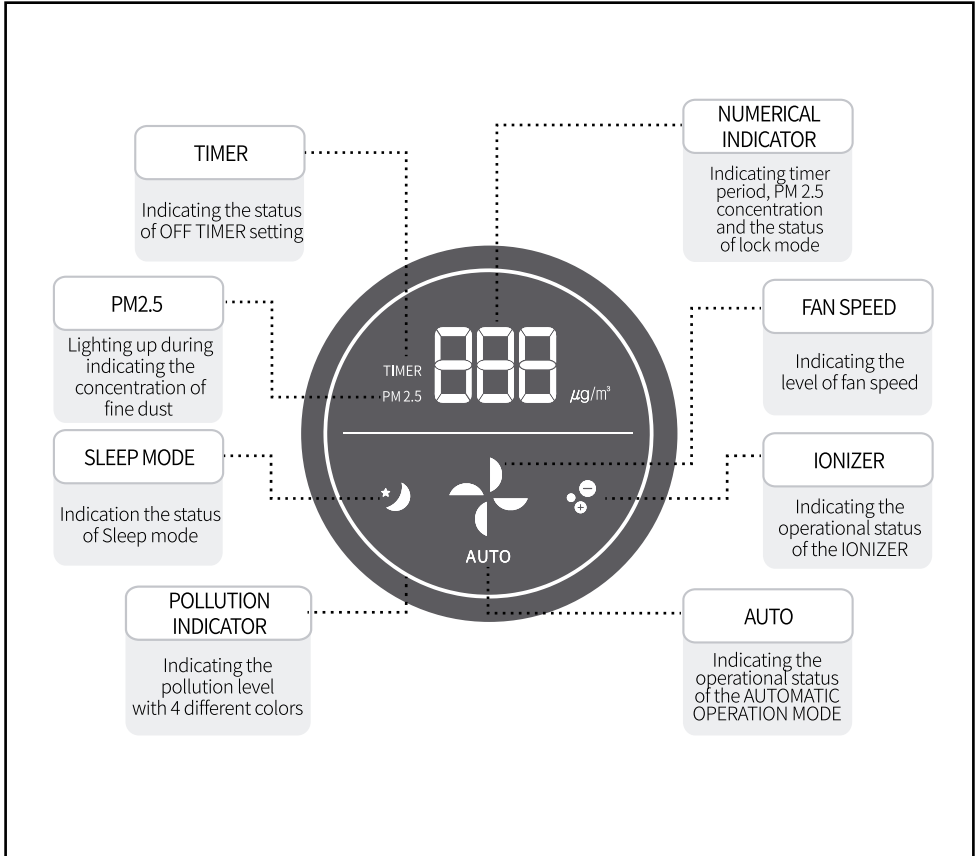

PM 2.5 COLOR INDEX



BLUE

Good:
0~15µg/m³



GREEN

Moderate:
16~50µg/m³



YELLOW

Unhealthy:
51~100µg/m³



RED

Very Unhealthy:
101~µg/m³

5. HOW TO USE



For your safety and proper use of the product, please read and understand the following before use.

POWER BUTTON

- Press the POWER ON/OFF button to turn the air purifier on or off.
- At first, the fan speed is set to AUTO mode.
- For 30 seconds after operation, the dust sensor is initialized.

During initialization, NUMERICAL INDICATOR does not state the PM2.5 level and the round pollution indicator changes color continuously. After 30 seconds, NUMERICAL INDICATOR and round pollution indicator will show the pollution level.

FAN SPEED

- Use this button to adjust the fan speed.

Repeated pressing of the Speed button while the air purifier is operating changes the fan speed, Auto step at a time, to the next speed in sequence. (Auto > 1 > 2 > 3 > 4 > Auto...)

- The fan speed is shown by the number of blue lighted fan in the display.
- Even if you press the speed button in step 4, the grill does not stop revolving to maximize performance of air purification.



STEP 1

STEP 2

STEP 3

STEP 4

ROTATION BUTTON

- Use this button to turn the grill rotate function on or off. improve performance of air purification.
- The grill rotation improves performance of air purification.
- It is normal that the grill may not revolve smoothly due to a high volume of air.

TIMER BUTTON

- The Timer feature instructs the air purifier to automatically power off a pre-determined time ranging from 1 hour to 12 hours.

Repeated pressing of the TIMER button while the air purifier is operating changes the timer setting, one step at a time, to next setting in the sequence: 1 hr., 2 hrs., 4 hrs., 8 hrs., 12 hrs., OFF.

- If the timer is set, "TIMER" LED in the display lights up and the timer setting you select is shown in the numerical indicator of the display.

10 seconds after the timer is set, the numerical indicator will change to indicate the fine dust concentration.

But, "TIMER" LED in the display keeps lighting up while the timer is set.

SLEEP BUTTON

- Set the sleep mode for the lowest air-flow and the minimum brightness of the display. Button doesn't sound during the sleep mode.
- Press sleep button again to turn off the sleep mode.
- In the sleep mode, the grill stops and the rotation button doesn't work.
- In the sleep mode, you can set auto power-off for sleep by pressing the time button.

5. HOW TO USE

ION BUTTON

- Press this button to turn on the cluster ion generator. then the ion indicator illuminates.

LOCK BUTTON

- To set the lock mode, press the rotation and sleep buttons simultaneously for 3 seconds. The word "LOCK" in the display blinks 2 times with buzzer sound.
- The other buttons do not work when the lock mode is on. If you press the other buttons in the mode, the word "Loc" on the indicator illuminates with buzzer sound.

LEVEL OF THE ULTRA-FINE PARTICLES

What's the Fine dust

The size of the fine dust is lower than 10 μm .

What's Ultra-fine particles

The size of the ultra-fine particles is lower than 2.5 μm . And a study founded that smaller particles are more harmful to the body.

Therefore, the advanced countries have introduced the standard of the-ultra-fine particles since the late 1990s.

- Dust level is shown in number from 5 to 500.
- Dust level is established with reference to the data provided by a manufacturer of sensor.
- Ultra-fine particle level (colored) is made with reference to the ultra-fine particle level provided by the Ministry of Environment.
- Ultra-fine particle level shown on the product may differ from the announcements of the Ministry of Environment.
- The Ministry of Environment estimates the ultra-fine particle level using gravimetric method and beta-ray method. But HORIZON HA-500 air-purifier estimates the amount of dust and changes it into concentration. Therefore, the results could be different.
- Ultra-fine particle level may vary indoor and outdoor.

6. HOW TO REPLACE THE FILTER

PRECAUTIONS ON USING FILTER

1. Precautions for using filters

- Make sure to use Wonbong genuine filters.
- Contact service center to purchase filter.
- Refer to the opposite page for replacing filter.

2. Precautions for replacing filter.

- Make sure to disconnect the power cord before replacement.
- Make sure to remove vinyl of the new filter. If you use the air purifier with the filter covered by vinyl, a warpage or a fire could happen due to the unusual sound and overheating of the motor.
- No returns are allowed if you remove the packing of the set of the new filter.
- Please be careful when replacing filter and excuse the return policy.

FEATURES OF FILTER

1. Pre filter

Traps large particles in the air such as dust, fur, pollen, and so on.

2. UPFF (Ultrafine Particle Free Filter)

Removes fine contaminants larger than 0.3um such as dust, bacteria, mold, smoke and etc. in the air.

3. Carbon filter

Keeps fresh room air by removing formaldehyde and various odors that cause Sick House Syndrome.

FILTER REPLACEMENT CYCLE

	1st STEP	2nd STEP	3rd STEP
FILTER	Pre-filter	UPFF	Deodorant filter
PERIOD	About 4 months	About one year	About one year
CLEANING METHOD	Vacuum the filter once a month	Not cleanable	Not cleanable

6. HOW TO REPLACE FILTER

1. Disconnect the power plug and pull out the filter cover at the rear of the product.

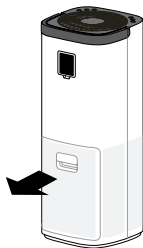

2. Pull out the whole cylindrical filter.

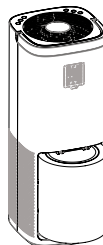

1. Pre filter

· Remove the pre filter attached by double-sided tape at the exterior of the filter

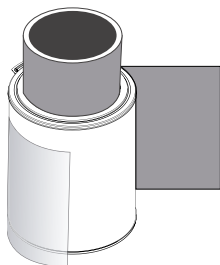

· Remove the film of the double-sided tape at the ends of the new pre filter and attach the new one to the UPFF (Ultrafine Particle Free Filter).

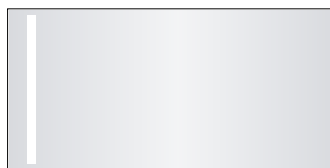

Remove the film of the double-sided tape.

2. Carbon filter and UPFF (Ultrafine Particle Free Filter)

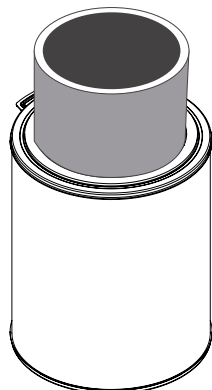

· Pull out the carbon filter and replace UPFF (Ultrafine Particle Free Filter) and carbon filter with new ones.

The replacement period for UPFF (Ultrafine Particle Free Filter) and carbon filter is one year.

· As the pre filter is attached, it is replaced together with carbon and UPFF (Ultrafine Particle Free Filter) filter.

· Reassemble in reverse order of disassembly

7. CLEANING METHOD FOR PRE-FILTER

- Clean the pre-filter with a soft cleaning brush or vacuum cleaner once a month
- When using vacuum cleaner, clean softly with the lowest suction power.
- Do not use benzene, alcohol, volatile detergents and hot water (over 40°C) that cause damages and discoloration.
- Adjust the cleaning cycle depending on the amount of the air purifier used or air pollution around.

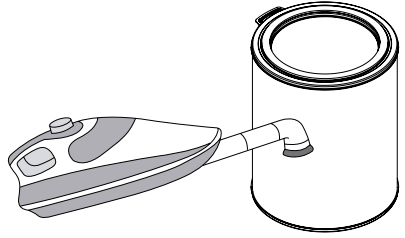

HOW TO CLEAN THE PURIFIER

1. OUTSIDE

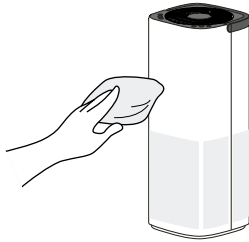

Clean the purifier with a cloth soaked with water or neutral detergent. And wipe it with a dry cloth.

2. INSIDE

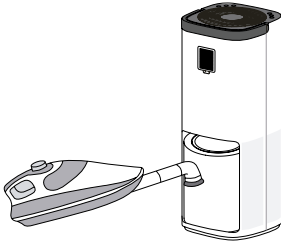

Open the cover filter on the rear and vacuum inside.

HOW TO CLEAN THE DUST SENSOR

- Disconnect the power cord before cleaning.
- Open the cover of the dust sensor on the rear and wipe the lense carefully with a cotton swab.
- Clean the dust sensor once every 6 months.
- You can adjust the cleaning cycle depending on the amount of the purifier used or air pollution around.



8. SOLUTION TO COMMON PROBLEMS

Read the following troubleshooting carefully before requesting customer service.

If problems is persistent, please contact Service Center.

PROBLEM	LIKELY CAUSES	ACTIONS
The air purifier doesn't work	Check if the power cord is connected well.	Connect the cord to the product well.
	Check if it is power outage.	Check if it has electricity and turn on the purifier again.
AUTO mode doesn't work.	Check if the power cord is connected well.	Disconnect and connect the cord again and press the button to control
	Check if you selected the automatic mode.	Press the fan speed button to select the AUTO mode (Check the illumination on AUTO mode indicator)
Red light on the indicator of the cleanliness Level	Have you cleaned the sensor? Check if the sensor is blocked.	Clean the dust sensor. Contact service center if the indicator is still on red after cleaning.
Massive vibration and loud noise.	Check if the purifier is on the uneven place.	Place the purifier on the flat surface.
Power cord and concent getting hot	Check if the power cord is connected well.	Connect the cord to the product well.
Unusual smell from the purifier.	Do you use the purifier in the smoky place with lots of smells.	Clean the air inlet and pre-filter. Replace the filter.
Weak air flow Air purification doesn't work.	Check if the grill is covered with lots of dust or is blocked by some stuff.	Remove the stuff on the grill and replace the filter.
Unusual display on the indicator	The lamp of the fan speed keeps blinking with ring sounds.	The air purifier has a problem. Please contact service center.
Unusual sound	Crackle sound from the air purifier	The clust ionizer may make the sound during operation.



Please contact service center for After Service or filter replacement if you have problems of the air purifie.



Wonbong shall not be liable for any loss or accidents from repairs/modification or filter replacement done by someone else who is not Himaster or Rudi.

9. SPECIFICATIONS

- PRODUCT NAME: HORIZON air purifier
- MODEL: HA-500
- POWER RATING: AC 220-240V / 50Hz
- SIZE: 275(W)x 278(D)x 710(H) mm
- WEIGHT: 7.3kg
- POWER CONSUMPTION: 37W

10. WARRANTY

PRODUCT

DATE OF MANUFACTURE

DATE OF PURCHASE

CUSTOMER'S NAME

DEALER'S NAME

WARRANTY GUIDE

1. The warranty period is 12 months from date of purchase.
2. The product will be repaired at cost in following cases:
 - After expiry of free warranty period
 - Malfunction of the unit caused by careless or abnormal use
 - Malfunction of the unit caused by natural disaster
 - In case of lost of this manual

NOTES

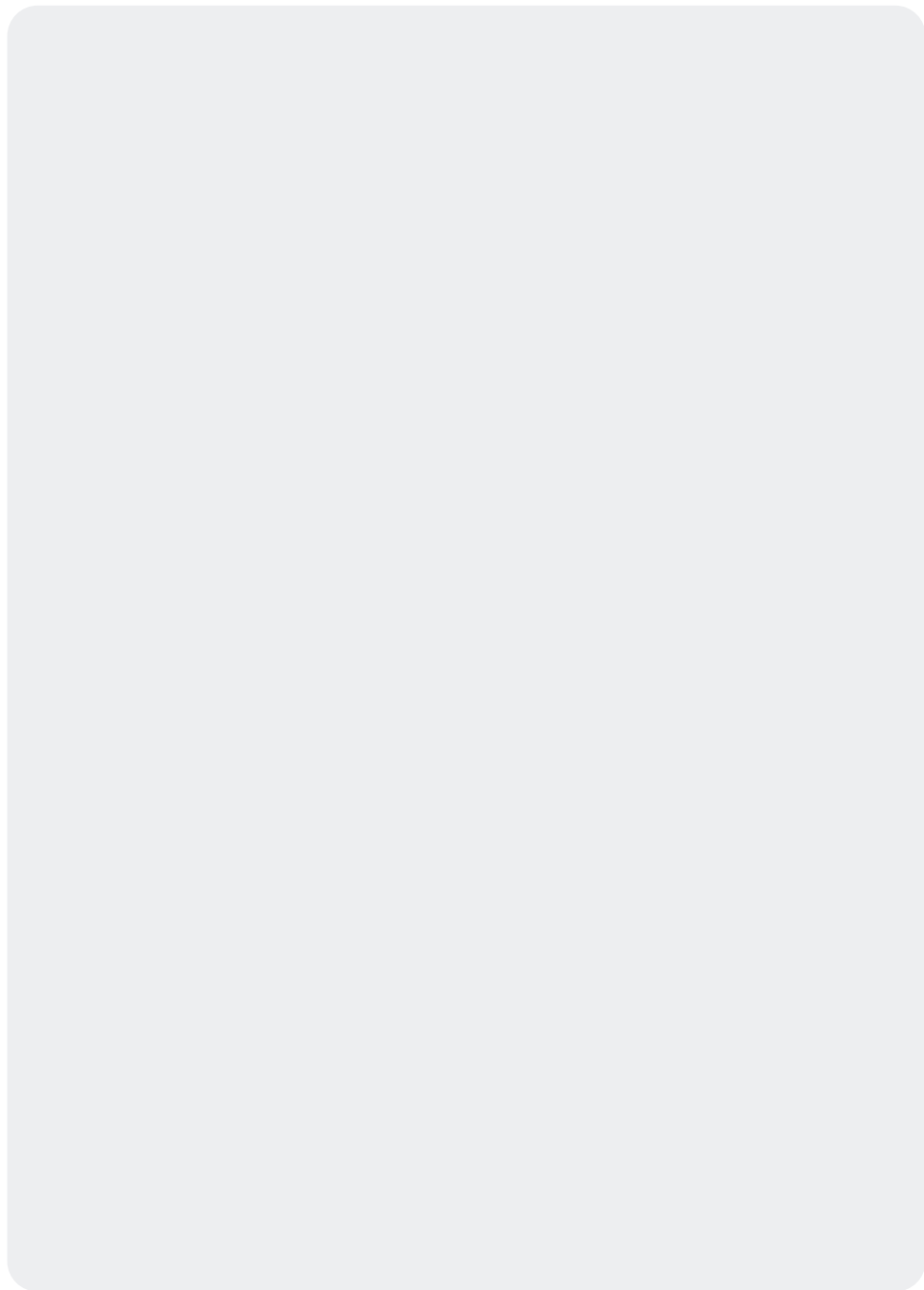

HA 500

Air purifier

horizon

A I R P U R I F I E R